

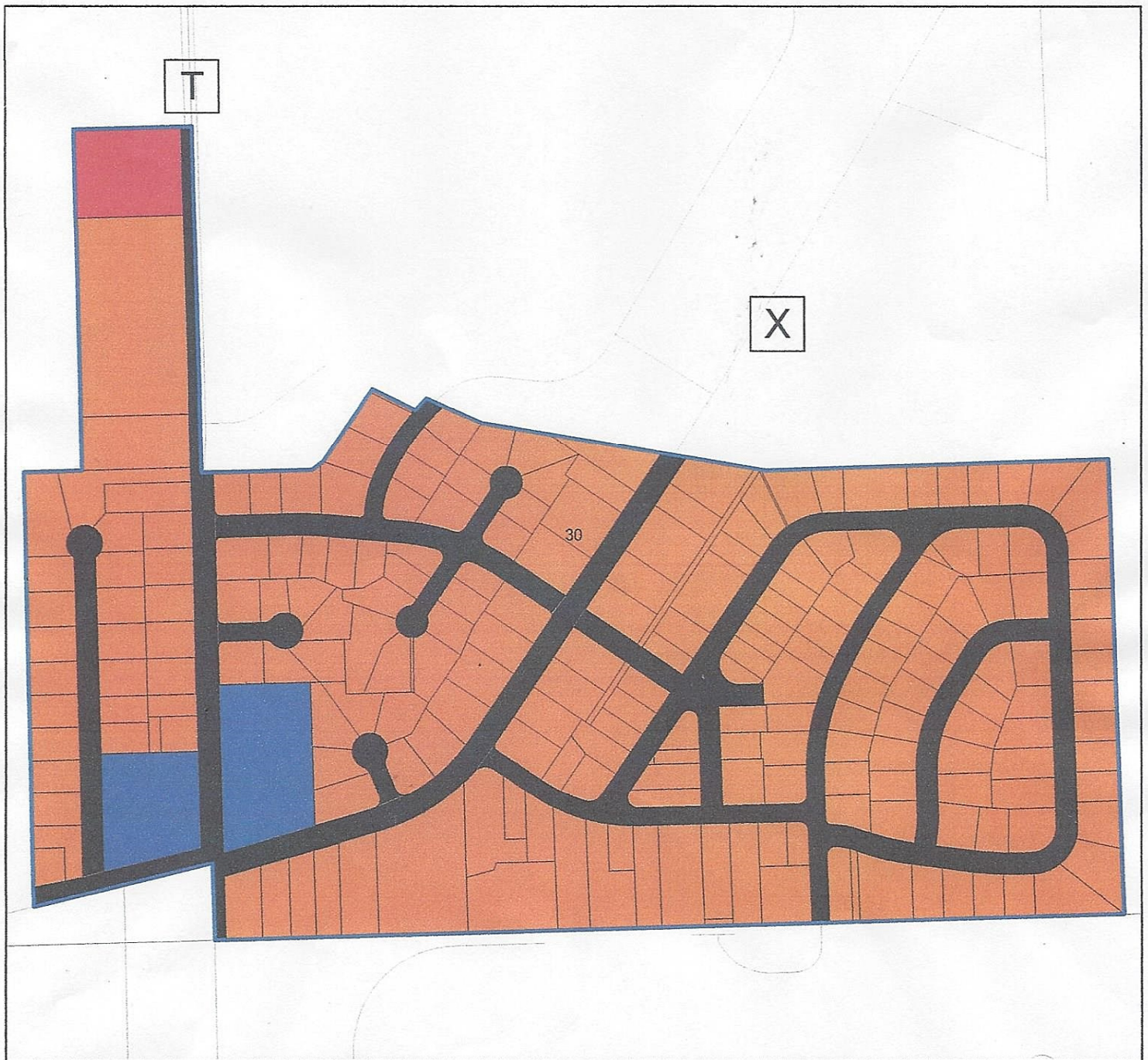



# Village of Elmwood Park Zoning Map

December 10, 2015

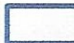
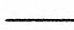

-  MEDIUM DENSITY RESIDENTIAL (6,200 SQUARE FEET TO 18,999 SQUARE FEET PER DWELLING UNIT) R-1
-  COMMERCIAL B-1
-  STREETS AND HIGHWAYS

-  GOVERNMENTAL AND INSTITUTIONAL P-1
-  VILLAGE BOUNDARY
-  PARCEL LINE

